

# fast<sup>®</sup> TRIMSTEEL TOOLING

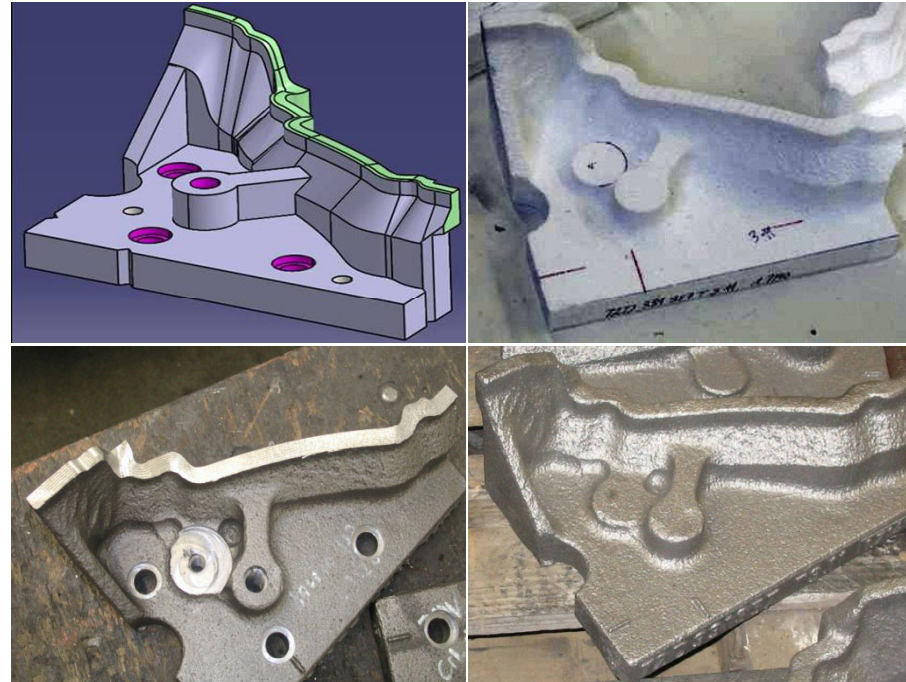

## Automated design of trim steels and forming tools



[www.cenit.de](http://www.cenit.de)  
[www.cenit-group.com](http://www.cenit-group.com)

# Contents

- Product description
- Position in engineering process
- Product usage process steps
- Product details
- Prerequisites
- Product packaging

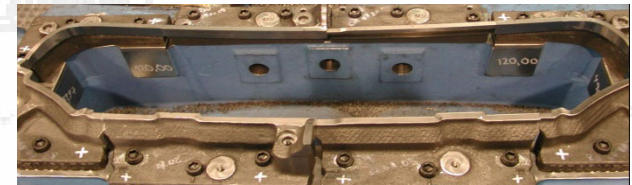
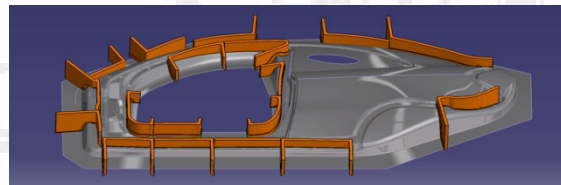
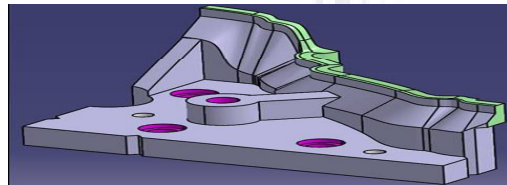

# Product description

- **Automated generation of trim steel geometry**
  - **FASTTRIMSTEEL** is a dedicated solution to easily design and modify trim and forming tools
    - The application computes:
      - Solid geometry for trim or forming tool
      - Trim surfaces for NC programming
  - **FASTTRIMSTEEL** is a close cooperation between the Swiss company iCapp and CENIT

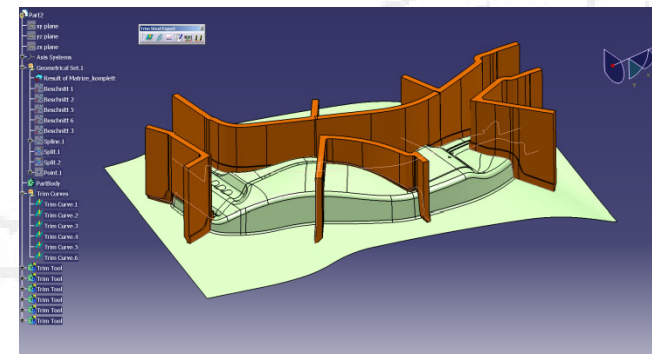

**fast**® TRIMSTEEL  
TOOLING

# Position in engineering process

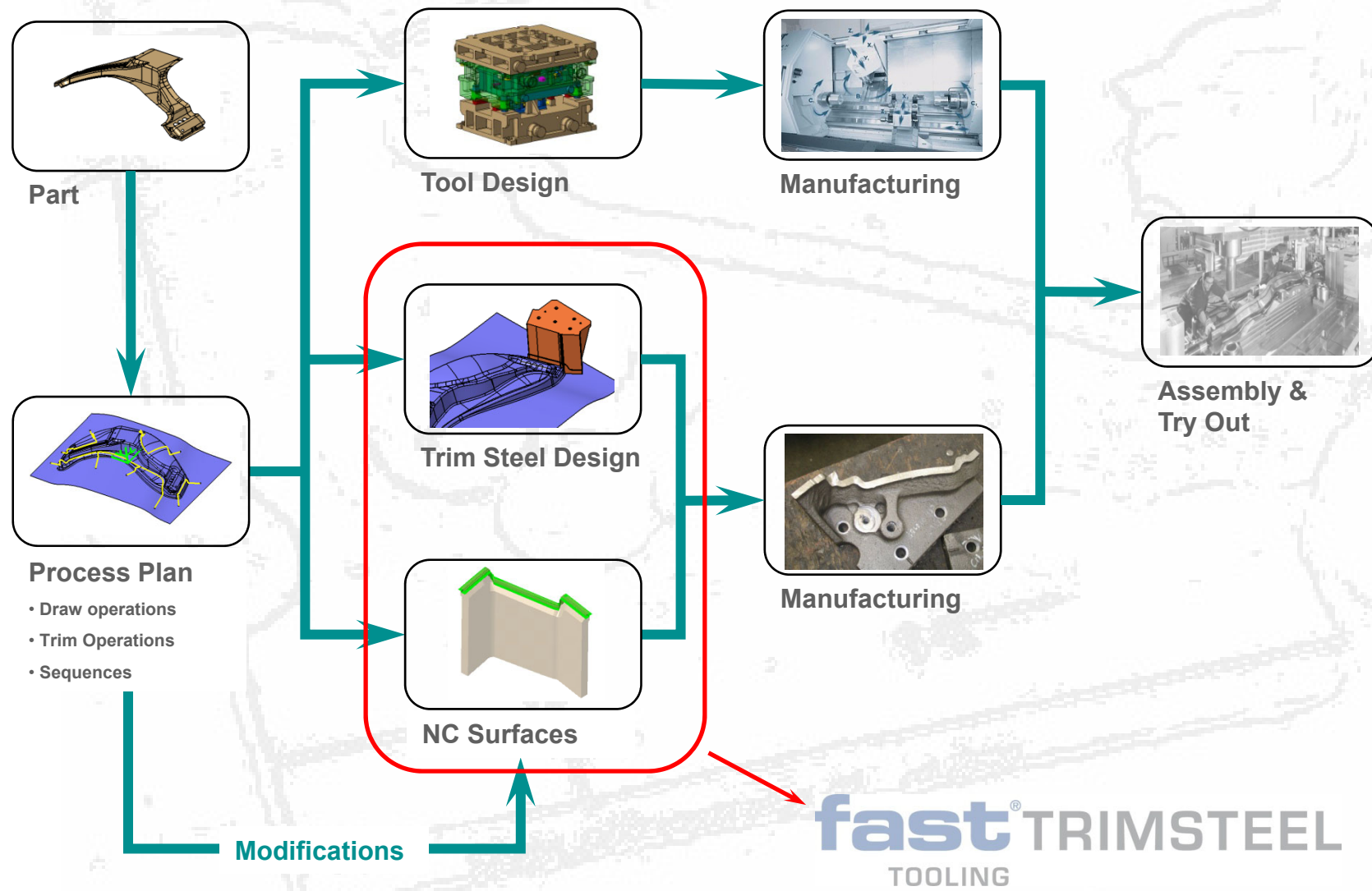

# Product usage process steps

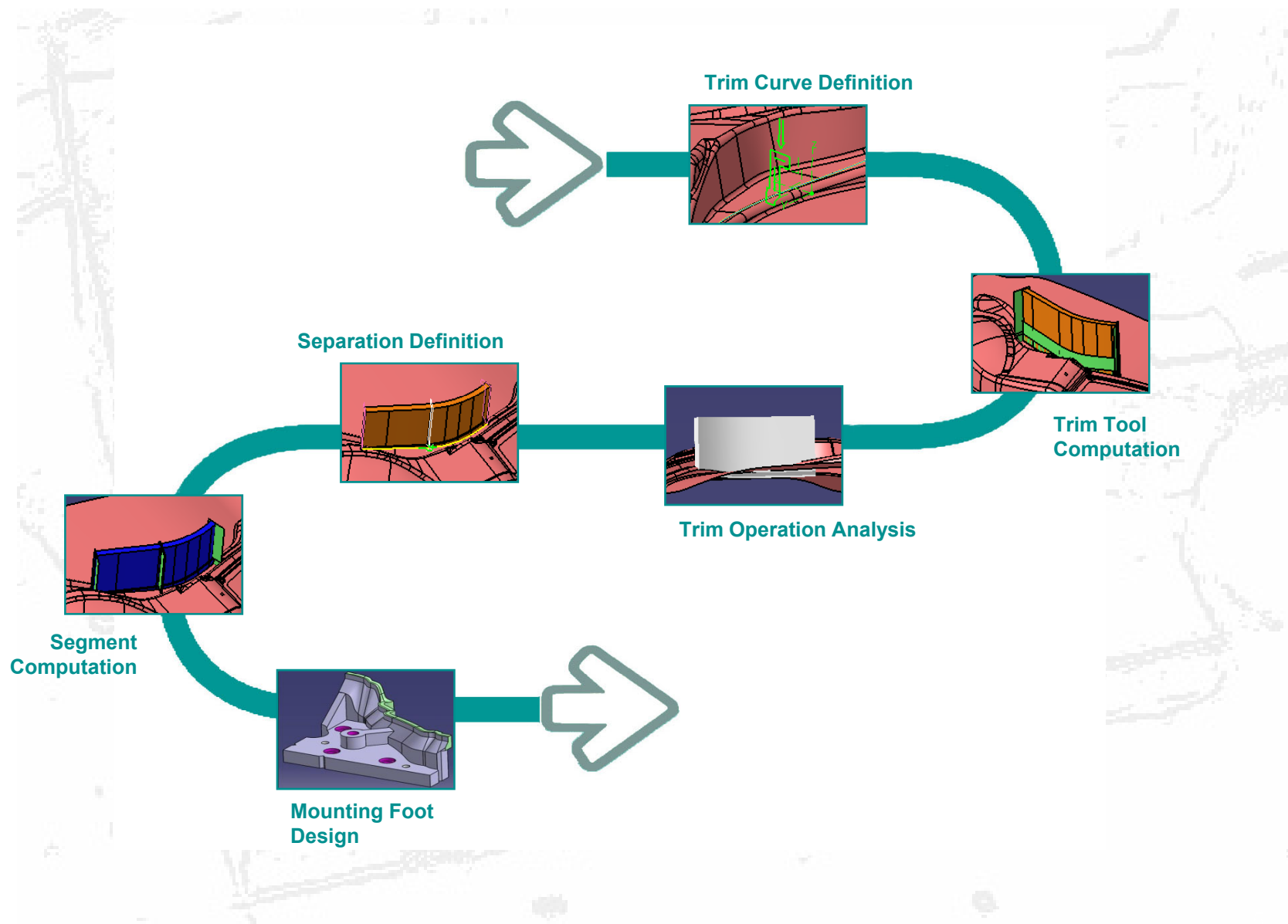

# Product details

- **Trim Curve Definition**
  - **Collect base information**
    - Tool operation direction
    - Surface to be cut
    - Trim contour
  - **Define trim tool orientation**

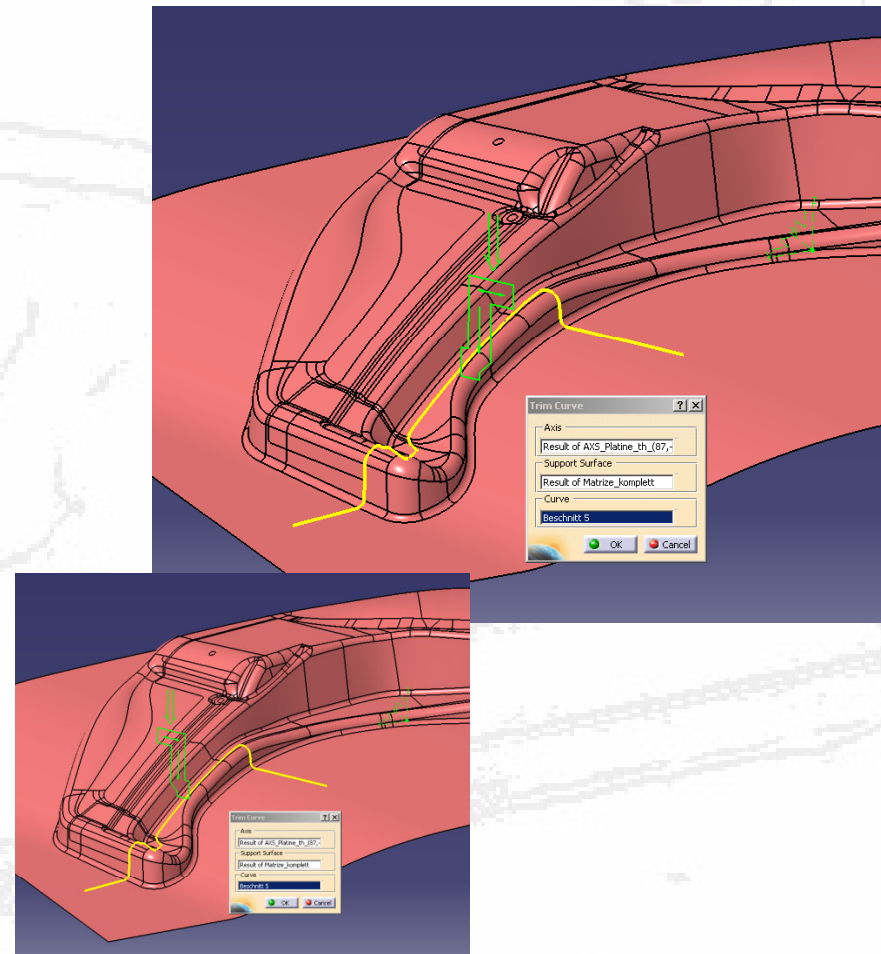

# Product details

- **Trim tool computation**
  - **Definition**
    - Tool shape and dimensions
    - Cutting parameters
    - Cutting behaviour (shear)
  - **Computation**
    - Cast body
    - NC tool surfaces
    - Collision check

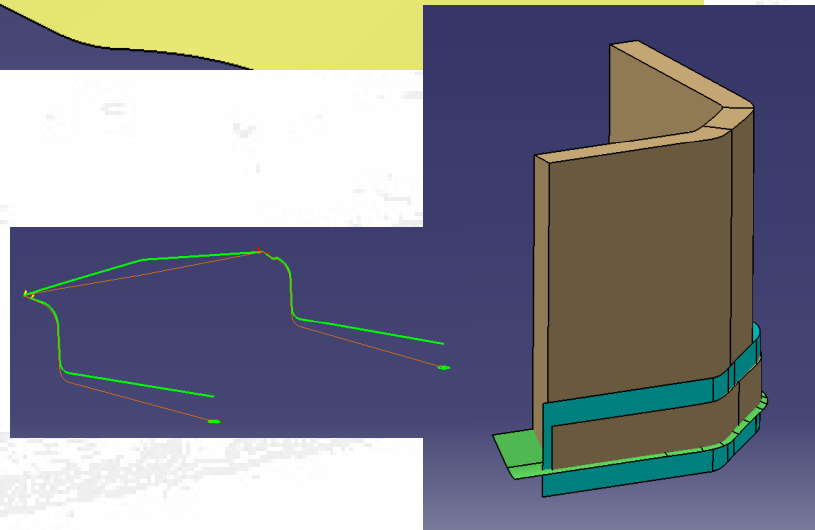
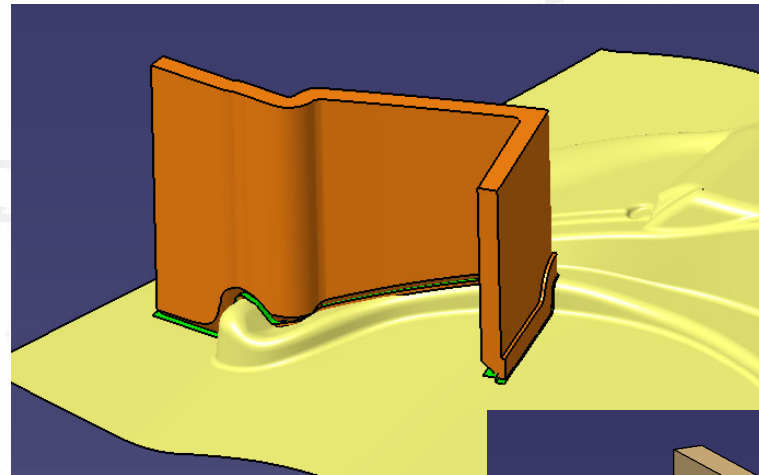

# Product details

- Trim tool computation
  - Tool shape and dimensions
    - Editable dimensions
    - Different types of head blade face
    - Storage in database

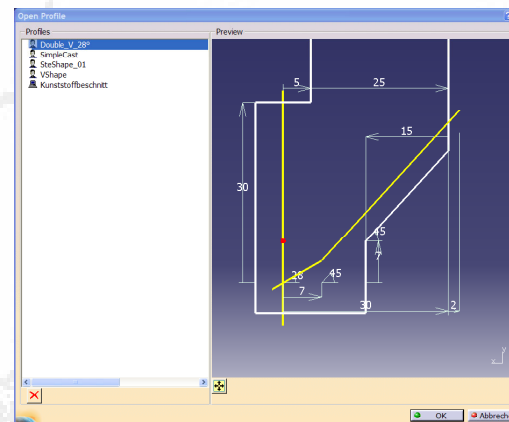
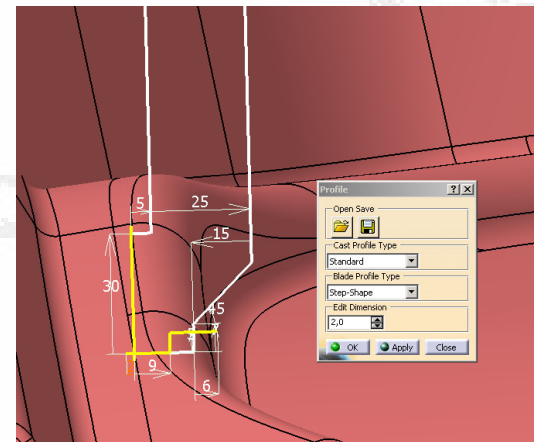

# Product details

- Trim operation analysis
  - Visual analysis of intrusion behaviour of trim tool

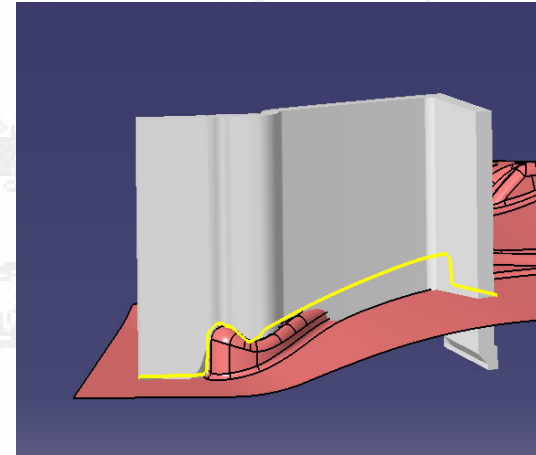
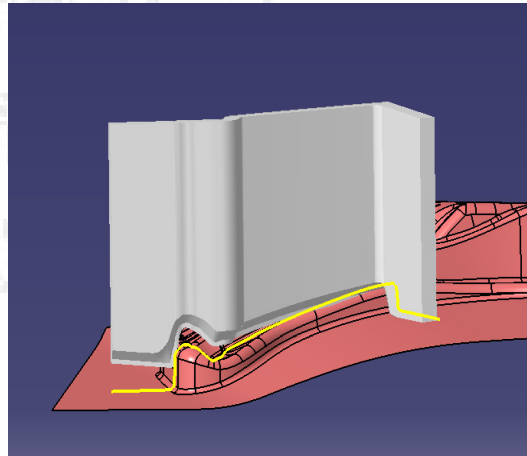
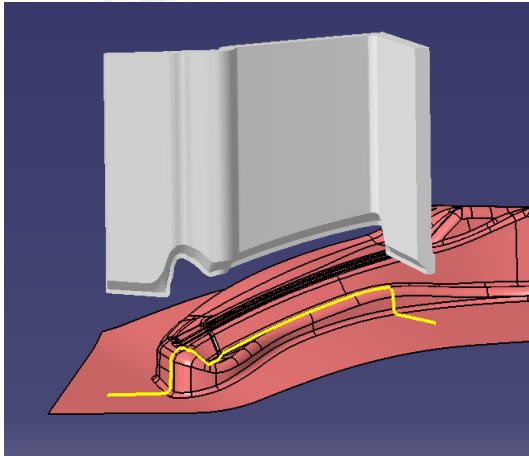

# Product details

- **Segmentation**
  - **Separation point definition**
    - Overlap
    - Orientation of separation point
  - **Segment**
    - Inheritance of definition and parameters of trim tool
    - Contact relief

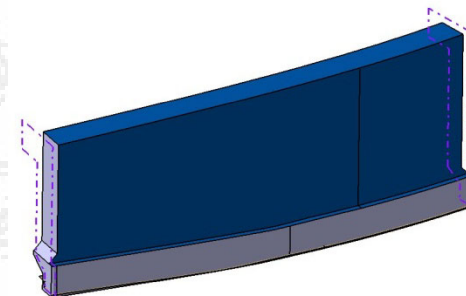
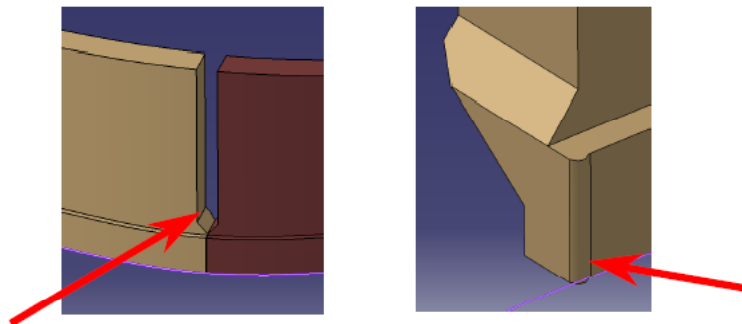
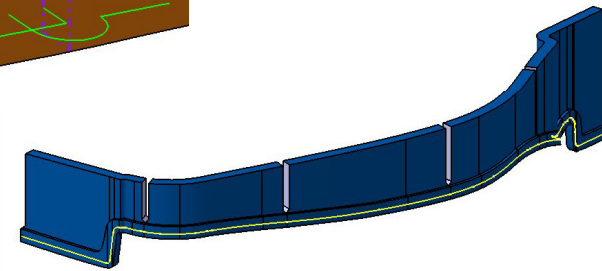
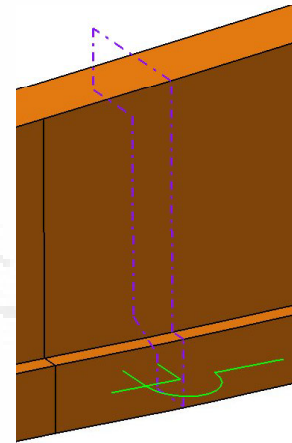

# Product highlights – What's next

- **Mounting foot**
  - **Base plate**
  - **Mounting holes**
    - Mounting
    - Positioning and fixation
  - **Local coordinate system**
    - Markings
  - **Others**
    - Stiffener ribs
    - Ejector position
    - Text engraving

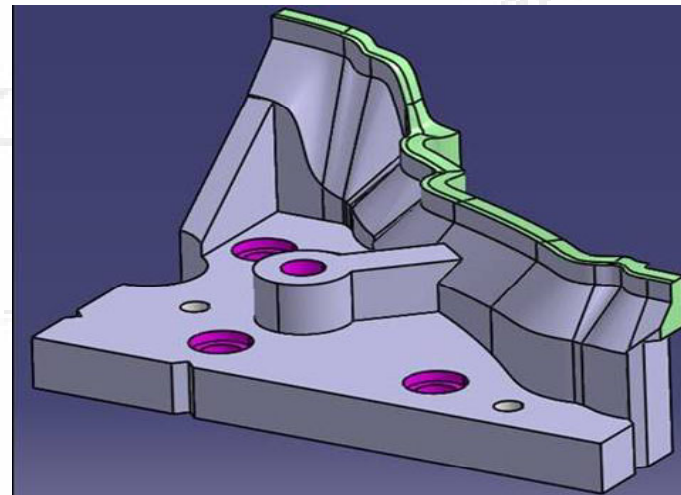

# Prerequisites

- **System requirements**
  - Windows XP (or Vista) 32bit and 64bit platform
  - Licensing with FlexNET Publisher (nodelock and floating)
  
- **Supported CATIA V5 Version**
  - Available for R16 and higher, all common used Service Packs
  - On request for any required Service Pack
  
- **CATIA V5 prerequisites**
  - Minimum required: MD1 configuration, or similar PLM Express configuration

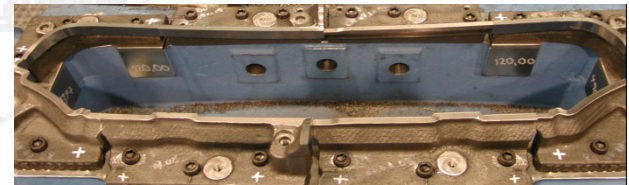
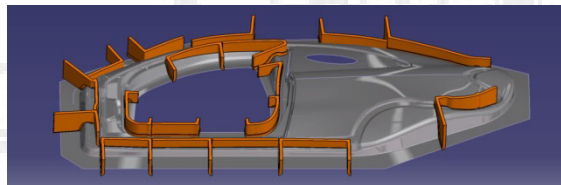
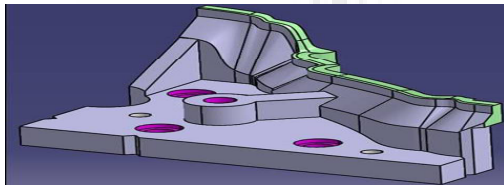

# Product Packaging

## ■ Modules

- Trim Steel Design
- Segmentation
- Mounting Foot Design (2009)

## ■ Configurations

- **FASTTRIMSTEEL Base**
  - Contains Trim Steel Design + Segmentation
- **FASTTRIMSTEEL Advanced**
  - Trim Steel Expert Base + Mounting Foot Design
- Inclusive
  - Installation support
  - Software updates
  - Hot-line support
- Exclusive
  - Training

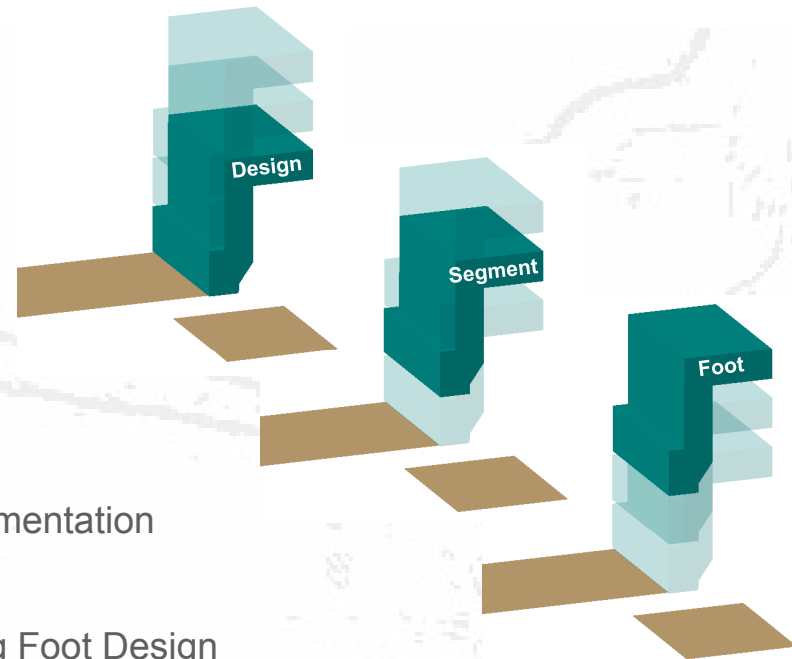

***Thank you for your attention!***

**© CENIT  
Industriestraße 52-54  
D-70565 Stuttgart**

**Phone: +49 711 7825-30  
Fax: +49 711 7825-4000**

**[www.cenit.de/fasttrimsteel](http://www.cenit.de/fasttrimsteel)**

## ***Disclaimer***

**This document may contain forward-looking statements regarding the business, financial and earnings situation of the CENIT corporation as well as earnings estimates. Forward-looking statements are characterised by such phrases and expressions as "the company may", or "the company will", "expects", "anticipates", "is considering", "is intending", "is planning", "believes", "continues to", "estimates" and other similar phrases and expressions. Such statements entail no assurance that anticipated events will transpire. On the contrary, such statements involve risks, uncertainty and contingencies that are difficult to predict and are furthermore based on assumptions regarding future events that may prove inaccurate. Actual outcomes may thus deviate substantially from expectations thereby expressed. Forward-looking statements made by CENIT representing expectations or projections of future events are made in good faith and may be presumed to be adequately grounded in fact; no assurance however can be provided that such statements, expectations or projections will be borne out/fulfilled/achieved. Actual operating results may vary substantially from those projected in forward-looking statements and are subject to specific risks - please consult the CENIT AG Systemhaus management report.**